





THE ANTARIS M72-SERIES



-  ANTARIS modules are manufactured from high-quality components for worldwide use in grid-connected systems.
-  Continuous quality controls throughout the entire production process
-  Production using state-of-art quality assurance technology
-  Quality assurance by an external, independent testing institute based in Germany

On the AS M6 series, we grant a 30-year performance guarantee and a 12-year product guarantee.



Also available
IN BLACK

AS M6 SERIES



ANTARIS SOLAR GmbH & Co. KG
Head office
63735 Aschaffenburg, Germany

Phone: +49 (0) 6095 950-441
Fax: +49 (0) 6095 950-544
Email: info@antaris-solar.com
Internet: www.antaris-solar.com

LIVING BY THE SUN!

ELECTRICAL PROPERTIES (STC*)

ANTARIS SOLAR AS M6 series	M72 310	M72 315	M72 320
Rated output (P _{max}) [Wp]	310	315	320
Voltage with P _{max} (V _{mpp}) [V]	36.5	36.67	36.74
Current with P _{max} (I _{mpp}) [A]	8.49	8.59	8.71
Open circuit voltage (V _{oc}) [V]	46.1	46.4	46.5
Short circuit current (I _{sc}) [A]	8.79	8.87	8.95
Output tolerance to rated output	0 - 5 W		
Max. reverse current (I _r) [A]	15		
Max. system voltage [V]	IEC 1000		
Degree of module effectiveness [%]	16	16.2	16.5
Application category	(as per IEC 61730) A		
Fire category	(as per IEC 61730) C(UL)		
Protection rating	(as per IEC 61730) II		

STC* (Standard test conditions): Irradiation 1000 W/m², module temperature 25°C, air mass 1.5

ELECTRIC OUTPUT WITH NOCT

ANTARIS SOLAR AS M6 series	M72 310	M72 315	M72 320
Rated output (P _{max}) [Wp]	234.6	238.4	242.2
Voltage with P _{max} (V _{mpp}) [V]	32.7	32.9	33.0
Current with P _{max} (I _{mpp}) [A]	7.17	7.08	7.36
Open circuit voltage (V _{oc}) [V]	42.1	42.3	42.5
Short circuit current (I _{sc}) [A]	7.48	7.55	7.62

NOCT: Irradiation 800 W/m², air 20°C, module temperature 45 +/- 2°C, air mass 1.5

TEMPERATURE PROPERTIES

NOCT**	45 +/- 2°C
Temperature coefficient P _{max}	-0.445 %/°C
Temperature coefficient V _{oc}	-0.334 %/°C
Temperature coefficient I _{sc}	0.05 %/°C
Operating temperature	from -40 to +85°C

NOCT**: Nominal cell operating temperature sun 800 W/m², air 20°C, wind speed 1m/s

MECHANICAL PROPERTIES

Solar cells	72 (6x12) monocrystalline silicon solar cells, 156 x 156 mm
Front surface	3.2 mm thick, low-iron solar glass
Rear side cover	Film compound (EVA/TPT)
Frame	Anodised aluminium
Diodes	3 bypass diodes
Junction box	Protection degree IP65
Plug-in connector	MC4 compatible
Cables	Length: 1250 mm / profile: 4 mm ²
Dimensions	1956 x 992 x 45 mm 77 x 39.1 x 1.77 inches
Weight	24 kg / 52.91 lbs
Snow load	5400 Pa
Wind load	200 kg/m ² (60 m/s)
Hail test	227 g steel balls from 1 m height
Performance guarantee	10 years at 90 %, 30 years at 80 % of the min. rated output

SCHEMATIC DIAGRAMM

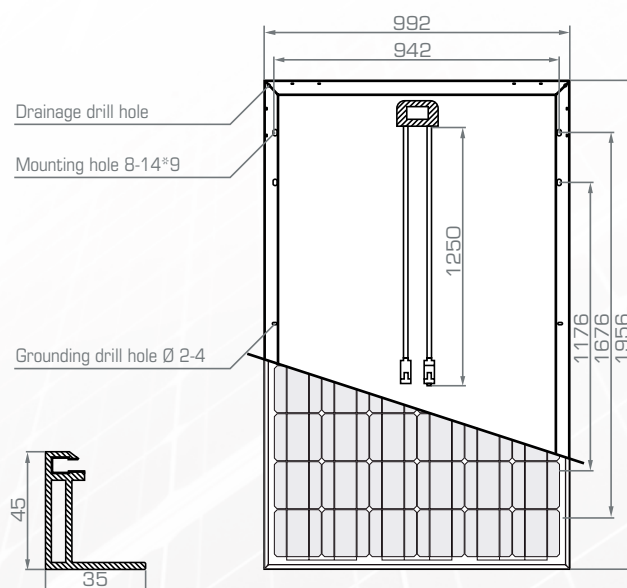

CURRENT-VOLTAGE CHARACTERISTIC CURVE

